



Noida Metro Rail Corporation Limited

E - Tender No. – NMRC/PD Area/Pari Chowk/347/2024

Name of Work- “ Tender for Licensing of Bare Commercial Space at Ground Floor at Pari Chowk Metro Station in NMRC Network”

Addendum-2

Summary Sheet

Sr. No.	Part/ Section/Sub-section	Description of table	Page No.	Clause No./Item No.	Addendum/Corrigendum	Remarks
1.	RFP – Site Layout and area of bare commercial space at Pari Chowk Metro station	Site layout area Sketch	90 of RFP	Annexure 1	Attached annexure A – Site layout area Sketch – 266 sqm	Replaced page 90 by 90R

Handwritten signature in blue ink.

$$A_1 = \frac{1}{2} \times 17.4 \times 23 = 200.10 \text{ m}^2$$

$$A_2 = 6 \times 10 = 60 \text{ m}^2$$

$$\text{Total} = 260.10 \text{ m}^2$$

$$\text{deduct Pier Area} = 2 \times 7 = 14 \text{ m}^2 \text{ (P1 + P2)}$$

$$\text{Net Area} = 266.10 \text{ m}^2$$

$$\text{Say } 266 \text{ m}^2$$

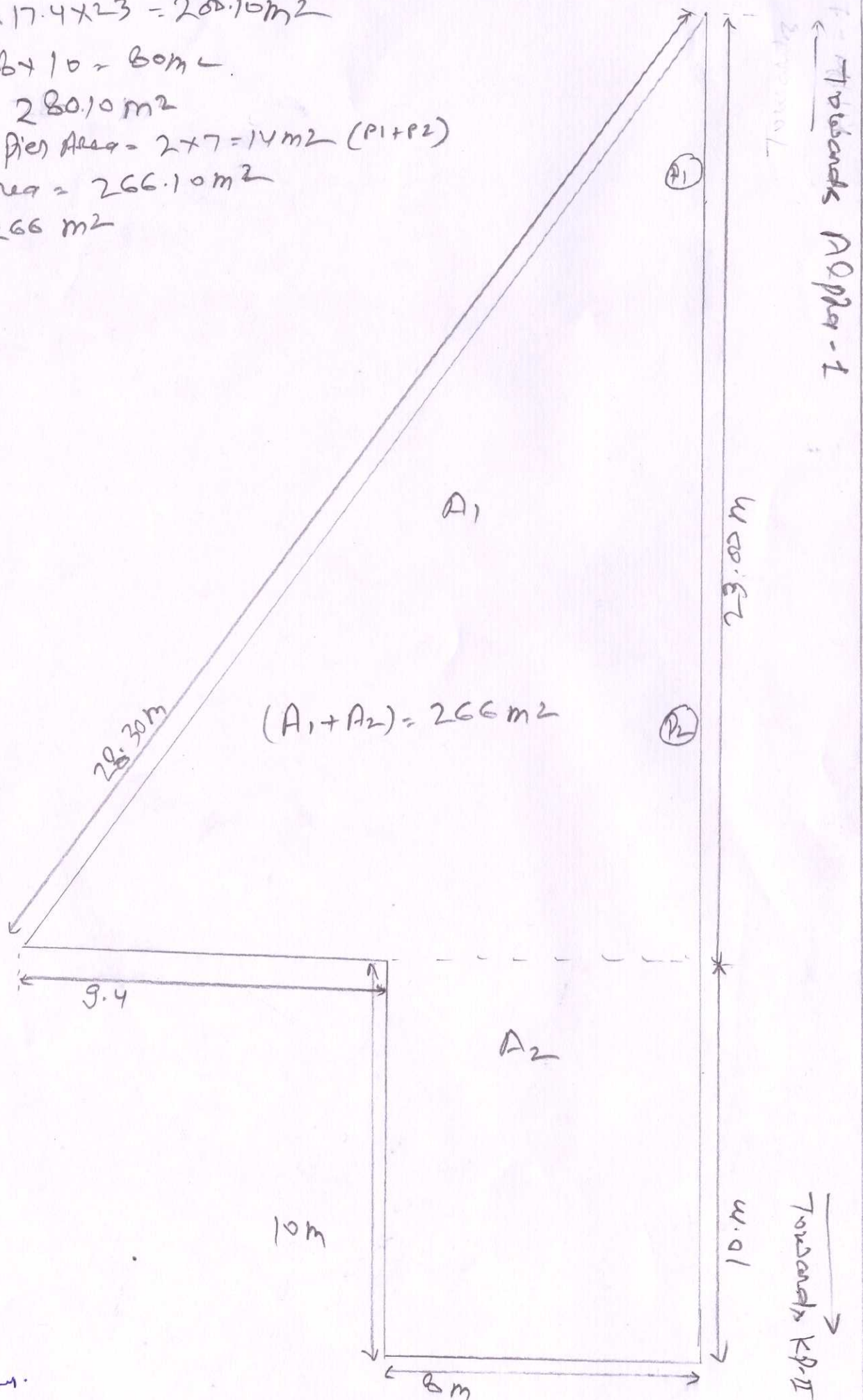

Sharma
Sya/Plum.